



Northwestern
Health Sciences University

Campus map: **Lower Level**

E Elevator

 Women's Restroom

P Parking

 Entrance Door

 Men's Restroom

 Stairs

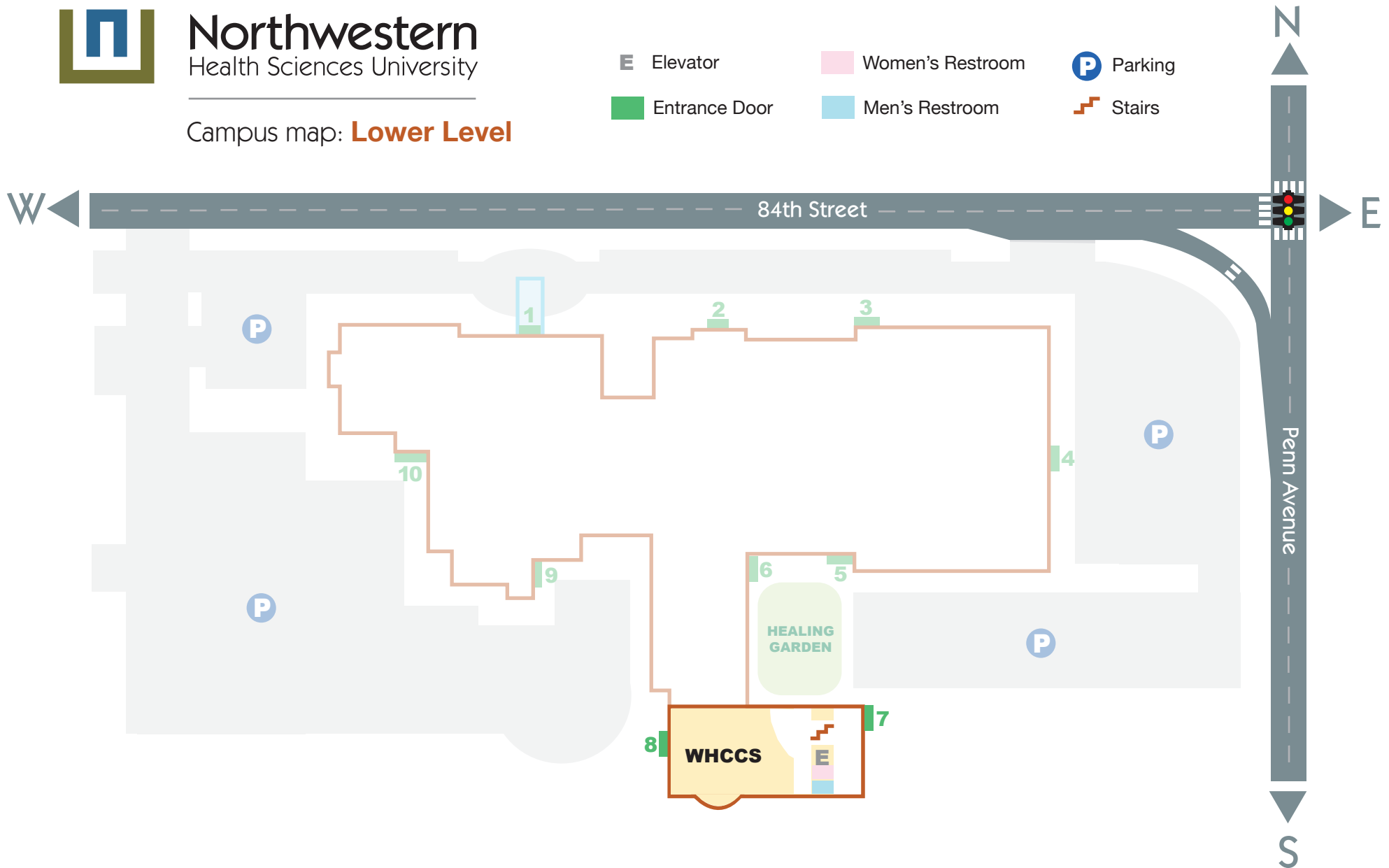

Wolfe-Harris Center for Clinical Studies **WHCCS**
(Rehab and Research Clinic)



E Elevator

 Women's Restroom

P Parking

 Entrance Door

 Men's Restroom

 Stairs

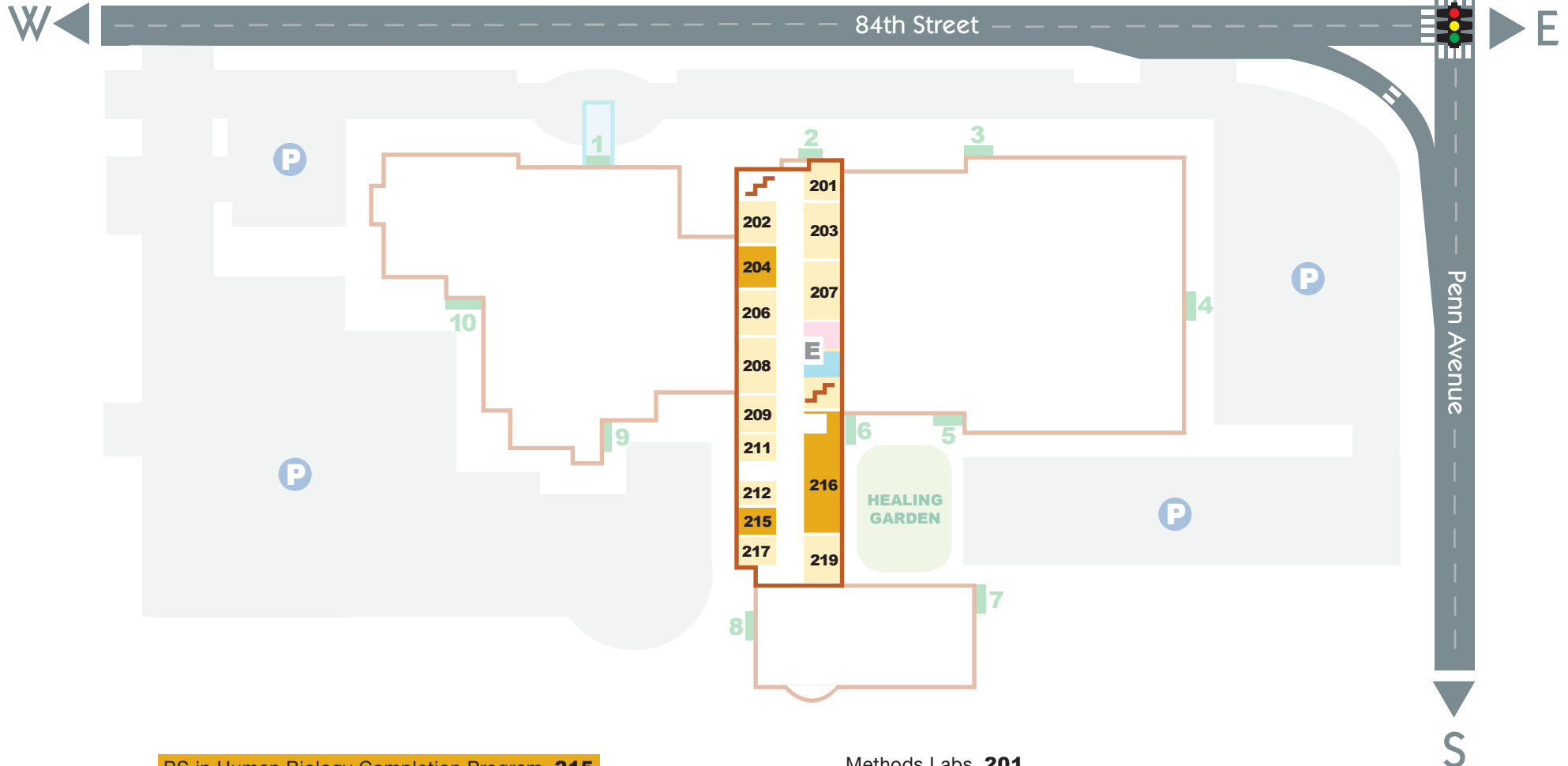

BS in Human Biology Completion Program 215

Classrooms **203, 206, 207**

College of Acupuncture and Oriental Medicine Faculty Offices **217**

College of Chiropractic Administration & Faculty Offices 216

College of Chiropractic Faculty Offices **212**

College of Undergraduate Health Sciences Administrative Offices 204

Faculty Lounge **219**

Methods Labs **201**

Radiological Consultation Services **216**

Radiology Lab **202**

School of Massage Therapy Administrative Offices 204

School of Massage Therapy Faculty Offices **208**

Technique Labs **209, 211**



E Elevator

Women's Restroom

P Parking

Entrance Door

Men's Restroom

Stairs

Campus map: **Street Level**

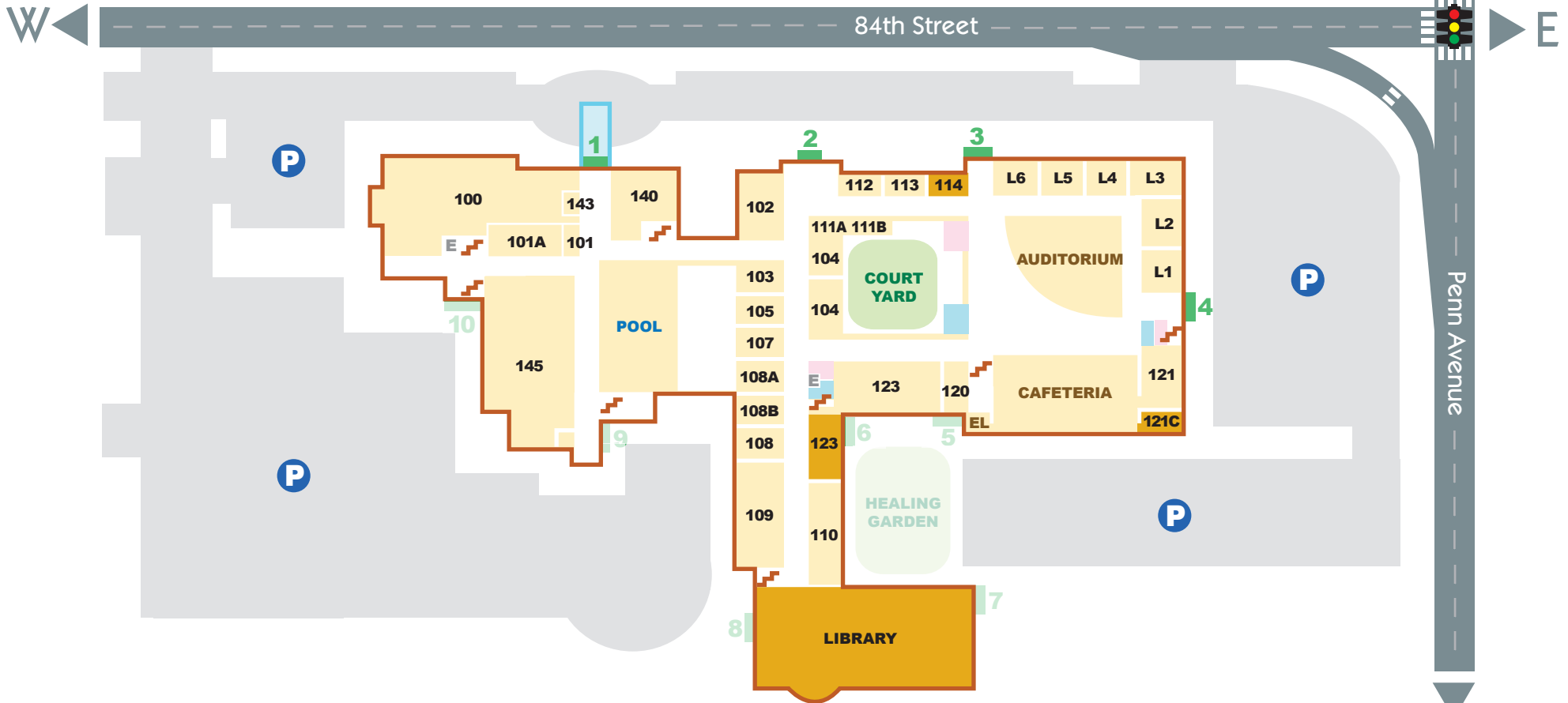

- Accounting **112**
- Administrative Offices **111A, 111B**
- Admissions **140**
- Bloomington Natural Care Center **100**
- Bookstore 123**
- Classroom **110**
- Clinical Laboratory **108A**
- Continuing Education **103**
- Employee Lounge **EL**

- Fetzer Board Room **120**
- Gross Anatomy Labs **108, 109**
- Gym **145**
- Histology & Clinical Pathology Labs **105**
- Human Resources **113**
- Kitchen **121**
- Laboratory Prep **108B**
- Lecture Rooms **L1, L2, L3, L4, L5, L6**

- Meditation Room **143**
- Microbiology Lab **102**
- Monte's Grill **CAFETERIA**
- Physiology & Biochemistry Labs **104**
- Registrar & Financial Aid 114**
- Rehab Suite **101**
- Smart Center **L2**
- Student Lounge 121C**
- Website Services **101A**



E Elevator

W Women's Restroom

P Parking

■ Entrance Door

■ Men's Restroom

⬆ Stairs

Campus map: **Garden Level**

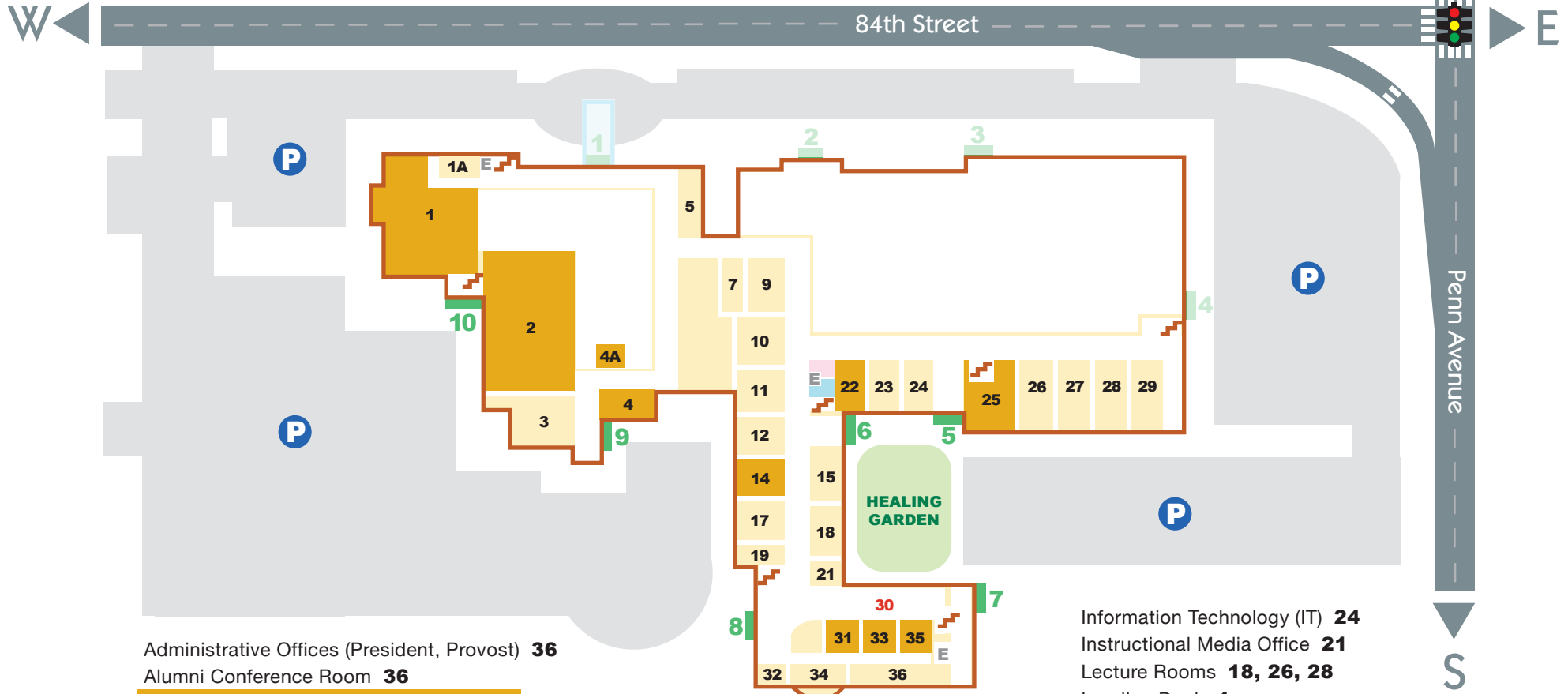

- Administrative Offices (President, Provost) **36**
- Alumni Conference Room **36**
- Alumni Services & Fund Development **31**
- Audio-Visual **19**
- Campus Security **4A**
- Clinic Billing **1A**
- College of Acupuncture & Oriental Medicine Administration Offices **22**
- College of Acupuncture & Oriental Medicine Clinical Education **23**
- College of Chiropractic Clinical Education **12**
- College of Undergraduate Health Sciences **17**
- Computer Lab **25**
- Copy Center & Mail Room **14**

- De Rusha Clinical Educational Center **1**
- Development **31**
- Edith Davis Teaching Clinic **5**
- Engineering **7**
- Executive Conference Room **32**
- Faculty Offices **17**
- Fireside Lounge **30**
- Fitness Center & Locker Rooms **2**
- Herbal Dispensary **5**
- Holtz Board Room **34**
- Human Resources Conference Room **9**

- Information Technology (IT) **24**
- Instructional Media Office **21**
- Lecture Rooms **18, 26, 28**
- Loading Dock **4**
- Lost & Found **4**
- Marketing and Strategic Communications **29**
- Physical Plant Director **4A**
- Receiving **10**
- Storage **3**
- Strategic Planning **11**
- Student Affairs & Career Services **35**
- Student Organizations Center **33**
- Techniques Lab **27, 15**
- University Health Services **1**